



HOSTED BY THE ST. JOHNS RIVER
WATER MANAGEMENT DISTRICT

**HYATT REGENCY HOTEL, JACKSONVILLE, FLORIDA
NOVEMBER 1 – 3, 2006**

W E L C O M E

Welcome to the 2006 Florida Public Land Acquisition and Management Partnership Conference (PLAM). What started as a relatively small, regional gathering in Winter Park in 1992 to discuss acquisition partnership opportunities has grown to be a statewide, annual conference to explore current issues, network with fellow practitioners and learn from the leaders in our field about successes throughout the state.

As our state continues to grow in population, we recognize that public land acquisition initiatives within urban communities are increasing and contributing to the conservation patchwork we are all working so hard to assemble.

Therefore, this year's conference includes these challenges of working within this segment of our conservation landscape in a track entitled "Community Conservation Lands." Concurrently, sessions addressing "Wildlands: Sustaining Their Value in an Urbanizing Environment" offer more traditional PLAM topics.

Please join us at our welcome and general session "Conservation Lands – Should We Ever Get Rid of Any? And plan to stay through Friday to be inspired by Florida officials as we learn "What Comes After Florida Forever?" Secretary Castille will share an inspirational presentation with you during lunch on Thursday, November 2 followed by afternoon field trips and workshops.

As this year's host, the SJRWMD along with our program committee hopes you will leave better prepared and motivated to continue the tradition of excellence, which has been the hallmark of Florida's public conservation lands programs since our first workshop in 1992!

Sincerely,

Robert Christianson

HYATT REGENCY HOTEL ALL MEETINGS TAKE PLACE ON THE SECOND FLOOR

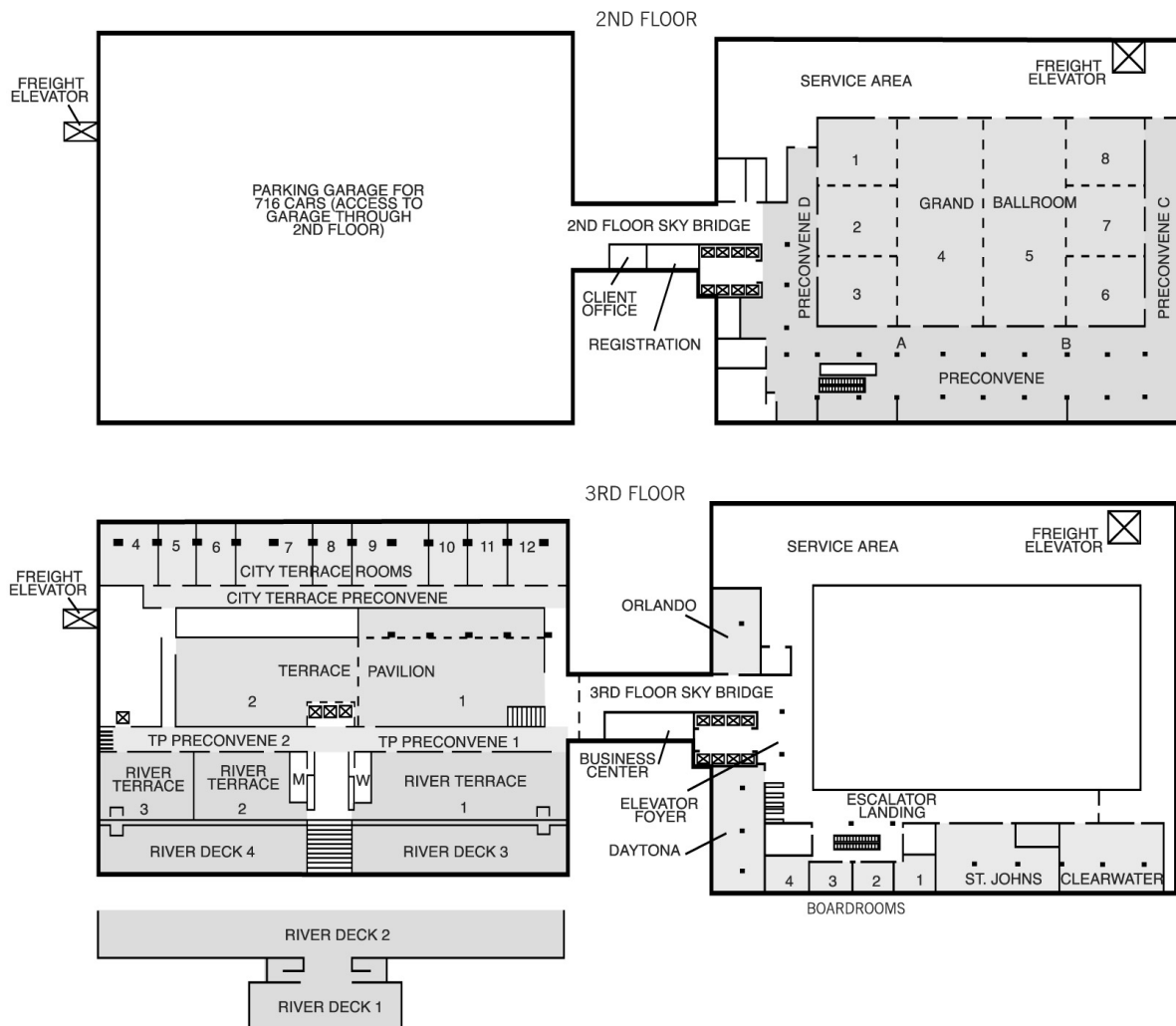

A SPECIAL *Thank You* TO OUR SPONSORS



American Government Services Corporation
www.agsc.biz



Bureau Veritas – Berryman & Henigar, Inc.
www.bhiinc.com



Florida Communities Trust
www.floridacommunitydevelopment.org/fct/



GCY, Inc
www.gcyinc.com



George F. Young, Inc.
www.georgefyoung.com



Jacksonville – Duval County Tourist Development Council
www.coj.net/City+Council/Tourist+Development+Council/



L.D. Bradley Land Surveyors
www.ldbradley.net

PLEASE VISIT EXHIBITORS DURING THE CONFERENCE

A SPECIAL *Thank You* TO OUR SPONSORS



Department of Environmental Protection
www.floridadep.org



Dyer, Riddle, Mills & Precourt, Inc
www.drmp.com



The Nature Conservancy
www.nature.org/florida



Dahill International Realty Co.
www.dahillrealty.com



Trust for Public Land
www.tpl.org



WilsonMiller, Inc
www.wilsonmiller.com

Henry Dean & Associates, LLC. and John H. Hankinson, Jr.

Aerostar Environmental Services, Inc
www.aerostar.net

E Sciences, Inc.
www.esciencesinc.com

England, Thims & Miller, Inc
www.etminc.com

Florida Division of Forestry
www.fl-dof.com

Keith and Schnars, P.A.
www.keithandschnars.com

Southeastern Surveying & Mapping Corporation
www.southeasternsurveying.com/contact.asp

The Conservation Fund
www.conservationfund.org

Agri-Property Consultants Inc.

Archaeological Consultants, Inc.
www.aci-crm.com

Florida Acquisition & Appraisal, Inc
www.flaa.com

Florida Recreation and Park Association
www.frpa.org

Glatting Jackson Hercher Anglin Lopez Rinehart
www.glatting.com

Alliance of Florida Land Trusts

Florida Bureau of Archaeological Research
www.flheritage.com

Florida Natural Areas Inventory
www.fnai.org

Natural Areas Training Academy
nata.snre.usf.edu

South Florida Water Management District
www.sfwmd.gov

U.S.D.A. Forest Service
www.fs.fed.us/r8/florida

A SPECIAL *Thank You* TO THE PROGRAM COMMITTEE

ALACHUA COUNTY

FLORIDA COMMUNITIES TRUST

FLORIDA DIVISION OF FORESTRY

FLORIDA DEPARTMENT OF ENVIRONMENTAL PROTECTION

FLORIDA FISH AND WILDLIFE CONSERVATION COMMISSION

FLORIDA RECREATION AND PARK ASSOCIATION

NORTHWEST FLORIDA WATER MANAGEMENT DISTRICT

SOUTH FLORIDA WATER MANAGEMENT DISTRICT

SOUTHWEST FLORIDA WATER MANAGEMENT DISTRICT

ST. JOHNS RIVER WATER MANAGEMENT DISTRICT (CHAIR)

SUWANNEE RIVER WATER MANAGEMENT DISTRICT

THE NATURE CONSERVANCY

TRUST FOR PUBLIC LAND

SILENT ACTION TO BENEFIT ALACHUA CONSERVATION TRUST

Alachua Conservation Trust (ACT) is one of Florida's most successful local land trusts, conserving environmental and historical sites in Alachua and surrounding counties since 1988.

Bidding Open
Thursday 8 a.m. – 5:30 p.m.

Announcements
6 – 7 p.m.

Exhibit Area, 2nd Floor



Conference coordinated by Center for Environmental Studies

Wednesday, Nov. 1

PRE-CONFERENCE MEETINGS

12:00 – 3:00 p.m. GRAND BALLROOM 6

Joint meeting of the Florida Greenways and Trails Council and the Florida Communities Trust Governing Board

Features an overview and update on the status of projects acquired through the Florida Forever programs that these organizations help administer, with an emphasis on the synergy between and distinctions of these programs. The meeting will include a recap of the Fall Legislative committee meetings and discussion on a successor program to Florida Forever. The agenda also includes presentations on the status of greenways and trails development in Florida from a regional perspective.

12:00 – 2:00 p.m. GRAND BALLROOM 7

Alliance of Florida Land Trusts Meeting

3:00 – 5:30 p.m. GRAND BALLROOM 7

Local Government Roundtable

An open discussion with local government staff and interested parties on current issues effecting local conservation lands including; land acquisition, land management, land use conflicts, etc. Format is collegial with topics solicited from those present for discussion in priority order determined by consensus.

3:30 – 5:00 p.m. GRAND BALLROOM 8

Challenges of Applying Multiple Funding Sources to Land Protection Projects

This meeting will describe obstacles and successes in federal partnerships using the 2002 Farm Bill programs within the Lake Okeechobee watershed. Panelists will discuss the experiences of government and non-profit land acquisition agencies in leveraging more than one funding source to achieve conservation land acquisition goals either through fee simple or less than fee conservation easements in south Florida.

6:00 – 8:00 p.m. RIVER DECK 1 & 2

PLA&M Partnership Conference Welcome Reception

Enjoy hors d'oeuvres and beverages while visiting with participants and sponsors in an informal, outdoor setting overlooking the St. Johns River.

Thursday, Nov. 2

Conference Facilitator: Robert Christianson, *St. Johns River Water Management District (SJRWMD)*

7:30 – 8:30 a.m. Light Breakfast EXHIBIT AREA

8:30 – 9:45 a.m. Welcome GRAND BALLROOMS 5 – 8

David Graham, *St. Johns River Water Management District Board Chairman*

Hot Topics 1: Conservation Lands – Should We Ever Get Rid of Any?

Moderator: Robert Christianson, *SJRWMD*

Panelists: Ernie Cox, *Family Lands Consulting*
Clay Henderson, *Holland & Knight LLP*
Manley Fuller, *Florida Wildlife Federation*

9:45 – 10:05 a.m. Break EXHIBIT AREA

10:05 – 11:30 a.m. Concurrent Sessions

TRACK 1 GRAND BALLROOM 5

Wildlands: Sustaining Their Value in an Urbanizing Environment

TRACK 2 GRAND BALLROOMS 6 – 8

Community Conservation Lands

10:05 – 11:30 a.m. CONCURRENT SESSION TOPICS

Wildlands: Creative Acquisition and Protection Strategies BALLROOM 5

Moderator: Eric Sutton, *Southwest Florida Water Management District (SWFWMD)*

Contemporary challenges created by a booming (and boomer) real estate market have changed the nature of acquisition negotiations from traditional purchase and sale agreements to complicated negotiations that often incorporate elements of growth management and/or partnerships with the private sector. This session will provide insight into growth management as well as recent examples of complicated, large tract negotiations. There will also be an overview of the real estate market provided by a well renowned economist.

Creating Visions for the Protection of Community Conservation Lands BALLROOMS 6 - 8

Moderator: Ken Reecy, *Florida Communities Trust (FCT)*

How do Florida's cities and counties identify and prioritize the natural and recreational lands that need to be protected for the public? Whether large or small, urban or suburban, communities are employing a variety of innovative tools and strategies to create the long-term visions for permanent green infrastructure. Whether referred to as open space planning, visioning, or greenprinting, these efforts provide useful guides for other Florida communities. Explore also how visioning intersects with formal growth management programs and planning requirements.

PRESENTATIONS

Growth Management's Role

Speaker: Wayne Daltry, *Lee County Smart Growth*

In-depth exploration of the relationship of growth management and land acquisition and management; how to better interface with growth management processes; examples of success and failures.

Open Space Planning

Speaker: David Barth, *Glattig Jackson Hercher Anglin Lopez Rinehart*

Florida communities that desire well-planned systems of open spaces are pursuing their creation through a variety of different strategies, tools, and partners. Learn how one of the Florida's foremost community planning and design firms assists cities and counties in creating long-term visions for parks and other permanently protected land. Explore the ways in which private sector planning professionals employ formal public participation, innovative urban design techniques, regional and master planning, and other means to help communities prioritize land protection objectives.

New Approaches to Protection and Recent Successes

Speaker: Eva Armstrong, *Department of Environmental Protection (DEP), State Lands*

With limited funding and escalating prices, are we done protecting large tracts of land? Perhaps there are projects that are currently underway that may lend optimism that it still can be done, i.e., Babcock Ranch acquisition.

Greenprinting

Speaker: Amy Paige Condon, *Trust for Public Land (TPL)*

Creating livable communities in Florida requires marrying the art of innovative planning with the technology of cutting-edge computer modeling. Learn from TPL's Community Vision Manager how competing interests can come together to identify the need for "green infrastructure," devise practical strategies for conserving important lands, and produce landscape-level conservation programs backed by broad public support and sound decision making.

Overview and Analysis of the Real Estate Market

Speaker: Stanley Geberer, *Fishkind and Associates*

An overview on today's real estate conditions, featuring discussion on density trends, geographic shifts in population, and expected outcome of cyclical downturns in Florida residential real estate.

Green Infrastructure: Linking Landscapes and Communities

Speaker: David Hansen, *Lake County*

Between 2002 and 2004 the population of Lake County grew by about one-quarter, and in 2004 county voters overwhelmingly supported a ballot measure to create the County's first conservation land acquisition program. In order to help decide what to buy, the County then contracted with the Trust for Public Land to create a "greenprint" designed to identify important resources that are important to the public and appropriate for protection. The County's Public Lands Manager will explain this process and how conservation priorities are being determined.

Wildlands: Creative Acquisition and Protection Strategies Panel Discussion

Eva Armstrong, *DEP*
Wayne Daltry, *Lee County Smart Growth*
Stanley Geberer, *Fishkind and Associates*
Eric Sutton, *SWFWMD*

Creating Visions for the Protection of Community Conservation Lands Panel Discussion

David Barth, *Glattig Jackson Hercher Anglin Lopez Rinehart*
Amy Condon, *TPL*
David Hansen, *Lake County*
Andy McLeod, *TPL*
Ken Reecy, *FCT*

Thursday, Nov. 2

11:30 – 12:45 p.m. Lunch GRAND BALLROOMS 1 – 4

Speaker: Colleen Castille, *Secretary, Department of Environmental Protection*
“Florida Forever Accomplishments”

1:15 – 5:30 p.m. Field Trips and Workshops

6:00 – 7:00 p.m. Silent Auction to benefit Alachua Conservation Trust
Book Signings by John Moran and James Valentine EXHIBIT AREA

7:15 – 10:00 p.m. Networking dinner/buffet and entertainment by “The Weeds” RIVER DECK 1 & 2

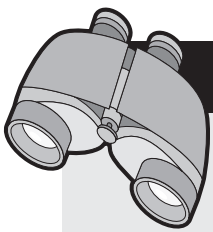

Field Trips



- **Pumpkin Hill Creek Preserve State Park:
Can You Cache This?**
- **Lower St. Johns River Boat Adventure**
Depart from the Hyatt Regency/Landing dock
- **Machaba Balu/Timucuan Preserve
Boat Adventure**
- **Camp Milton Historic Preserve &
Jacksonville-Baldwin Rail Trail
Bicycle Ride**
- **Julington-Durbin Preserve
Driving/Walking Tour**

**Field Trips depart from
Newnan Street at 1:15 pm.
Transportation by Carey Buses.**

Workshops

GRAND BALLROOMS 6 – 8

1:15 – 2:45 p.m.
**Environmental Site Assessments and the EPA's
New All Appropriate Inquiries: What it Means to
You**

Workshop Panelists:

Carol Brown
SJRWMD Division of Environmental Management

Philip Elson
Aerostar Environmental Services, Inc.

Daniel Richardson
Lewis Longman & Walker, P.A.

Melissa Gross-Arnold
Lewis Longman & Walker, P.A.

3:15 – 5:00 p.m.
**Wildlands – Urban Interface Management
Techniques: Fire, Forestry, and Exotic Plants**

Case Studies Presented By:

Steve Miller
St. Johns River Water Management District

Bill Helfferich
South Florida Water Management District

Walt Thomson
The Nature Conservancy

Pete Colverson
Pandion Systems, Inc.

Friday, Nov. 3

7:30 – 8:30 a.m. Light Breakfast EXHIBIT AREA
8:30 – 9:45 a.m. Concurrent Sessions

TRACK 1 GRAND BALLROOM 5

Wildlands: Sustaining Their Value in an Urbanizing Environment

TRACK 2 GRAND BALLROOMS 6 – 8

Community Conservation Lands

CONCURRENT SESSION TOPICS

Managing Wildlands in an Urbanizing Environment

Moderator: Bob Heeke, *Suwannee River Water Management District (SRWMD)*

Managing and maintaining the ecological values of wildlands has become increasingly more challenging as Florida experiences urbanization and demographic changes. With limited resources, it becomes more important for land management professionals to improve partnership relationships and communication as well as incorporate scientific and technological advances.

Financing the Acquisition of Community Conservation Lands

Moderator: Will Abberger, *Trust for Public Land*

How do Florida's cities and counties pay to acquire and manage their green infrastructure? In the past decade, more than 50 Florida local governments have enacted financing measures to protect key community lands. These successful local funding programs – often occurring in conjunction with visioning and planning – offer practical insights for other communities that seek to buy and manage land for the benefit of the public. Explore best practices for fiscal and political research, ballot measure design, public opinion surveys, and other elements of conservation finance.

PRESENTATIONS

Disease, Habitat Quality and the Gopher Tortoise

Speaker: Henry Mushinsky, *University of South Florida*

Repeated surveys of the gopher tortoise at ten public lands in Florida have suggested a general decline in population size at most but not all sites. The upper Respiratory Tract Disease (URTD) was known to be present at four of the ten sites prior to the resurveys, and was discovered at four additional sites during this research. Although the tortoise is in decline at some sites with URTD infected animals, not all such populations are in decline. Furthermore, changes in habitat structure have occurred during the decade between the two surveys and these changes also are associated with declines in the populations of resident tortoises.

Leadership in Conservation Administration

Speaker: Doug Weaver, *Volusia County*

The Volusia Forever Program, which was created in 2000 when Volusia County citizens voted to tax themselves .2 mills over 20 years to protect the County's natural biodiversity, is a top example of agency leadership for land conservation. Over the life of Volusia Forever it is anticipated that \$162 million will be raised and invested for public conservation.

Integrating New Management Concepts and Directions

Speaker: Kathleen Swanson, *Florida Fish and Wildlife Conservation Commission (FFWCC)*

Advances in technology and conservation planning can refine land management operations and improve wildlife habitat. Learn about development of management treatment data bases, objective-based vegetation monitoring, habitat prioritization tools, and ground cover restoration.

Conservation Finance

Speaker: Linda Greck, *Davie Area Land Trust*

In less than two years, a group of committed citizens in the Broward County town of Davie have achieved an extraordinary amount. A committee was organized to propose and advocate for a \$25 million open space bond – it passed with 60% of the vote in September 2005. This effort led to the creation of the new Davie Area Land Trust, which is now looking toward its first project. Learn about the role of community leadership in meeting the demand for local land conservation financing from an effective citizen volunteer.

Innovative Opportunities for Recreation on Wildlands

Speaker: Will Miller, *SWFWMD*

Changing demographics have created challenges in balancing demands for more and new recreation on wildlands, while at the same time protecting the natural values of the lands. This highly visual presentation will showcase unique recreation programs from different agencies.

Political Leadership in Conservation Finance

Speaker: Michael DiTerlizzi, *Martin County Board of County Commissioners*

Fast-growing Martin County faces substantial land use and land protection challenges. In November, 2006, the County's voters – following a unanimous vote of the County Commission in August – will decide on a half-cent sales tax increase for conservation and recreation land acquisition. What is the role of elected political leadership in achieving conservation financing at the municipal or county level? Learn from a public official who is providing just that leadership.

Managing Wildlands in an Urbanizing Environment Panel Discussion

Bob Heeke, *SRWMD*
Will Miller, *SWFWMD*
Henry Mushinsky, *University of South Florida*
Eric Sutton, *SWFWMD*
Kathleen Swanson, *FFWCC*

Financing the Acquisition of Community Conservation Lands Panel Discussion

Will Abberger, *TPL*
Michael DiTerlizzi, *Martin County Board of County Commissioners*
Linda Greck, *Davie Area Land Trust*
Andy McLeod, *TPL*
Doug Weaver, *Volusia County*

9:45 – 10:00 a.m. Break EXHIBIT AREA

10:00 – 11:00 a.m. Hot Topics 2: What Comes After Florida Forever? GRAND BALLROOMS 5 – 8

Moderator: Kirby Green, *St. Johns Water Management District*

Panelists: Thad Altman, *Florida House of Representatives*
Eric Draper, *Audubon of Florida*
Paula Dockery, *Florida Senate*

11:00 – 11:10 a.m. Closing Remarks